



3G1215X-MX-X-A ANTENNA FAMILY

Magnetic Flush Mount GPS L1/L2 FRPA

The 3G1215X-MX-X-A product family uses the Global Positioning System (GPS) signal reception in the L1 and L2 frequency bands. This antenna is designed to the standard Fixed Reception Pattern Antenna (FRPA) mounting footprint for easy integration onto new and existing platforms. The rugged enclosure can withstand harsh environmental conditions seen in military, aerospace and industrial applications. A magnetic mounting feature is included for easy installation. The “-A” version of this antenna family locates the output connector opposite the three magnetic mounts.

Antcom can customize this product family to meet your specific requirements. Please contact us for more information about customization options.

BENEFITS

- Rugged GPS L1/L2 antenna provides assured position, navigation and timing (PNT)
- Standard FRPA mounting footprint with a magnetic mount for easy platform integration
- Many standard options available, and customizable if required

FEATURES

- GPS L1/L2 with M-Code support
- FRPA footprint with magnetic mount and side-exit cable output
- Passive or active (amplified) configurations available
- Active configurations offer 2-stage integrated bandpass filtering with diode limiters
- Connector options available
- Paint color options available



OPTIONS

- | | |
|----------|--|
| COLOR | <ul style="list-style-type: none">• Gloss White• Lusterless Gray• Camo Green• Lusterless Black• Desert Tan |
| LNA GAIN | <ul style="list-style-type: none">• With 33 dB LNA• With 20 dB LNA• With 40 dB LNA• Without LNA |

ELECTRICAL

Frequency Range:	
L1 GPS	1575.42 ± 12 MHz
L2 GPS	1227.60 ± 12 MHz
VSWR	<2.0:1
Impedance	50 ohms
Polarization	RHCP

MECHANICAL & ENVIRONMENTAL

Designed to:

Weight	6.8 oz
Temperature	-55°C TO +85°C
Altitude	70,000 ft
Vibration	> 30 Grms

TYPICAL LNA PERFORMANCE

LNA Gain	See Options Table
LNA Noise Figure	3.5 dB
LNA P1dB Out	+13 dBm
LNA DC Power	(3.8 - 15) V <70 mA

LIMITING & FILTERING

Power Handling	1 Watt CW
----------------	-----------

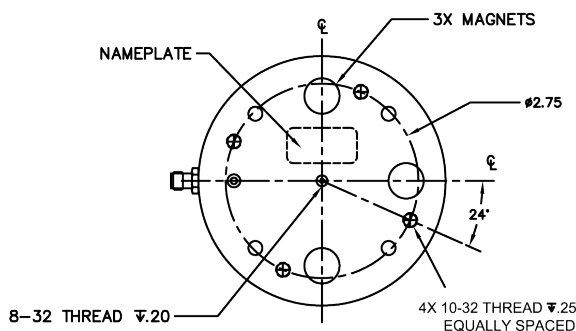
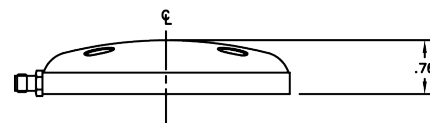
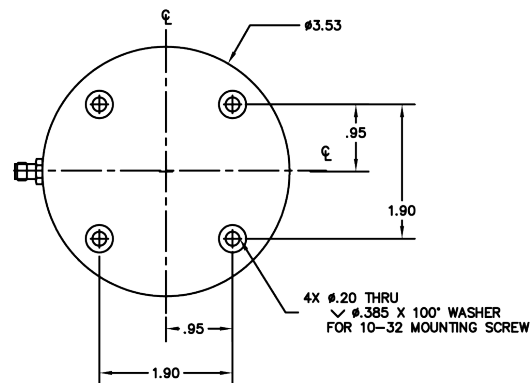

PART NUMBER DECODER

3G1215X-MS-X-A

LNA Gain
 A = With 33 dB
 A2 = With 20 dB
 A4 = With 40 dB
 P = Passive

Color (PER AMS-STD-595)
 1 = Gloss White #17925
 2 = Lusterless Gray #36320
 3 = Camo Green #34094
 4 = Lusterless Black #37038
 5 = Desert Tan #33446

CONTACT ANTCOM

Phone: +1-310-782-1076
 Fax: +1-310-782-1086
 Email: sales.pi.antcom@antcom.com
 Web: antcom.com

